

96-8-18,  
213

- Proceedings of Court of Inquiry or on men reported Missing on Active Service.....
- Attestation Papers.....
- Declaration of change of name.....
- Authority for special enlistments.....
- Documents of re-enlisted men.....
- Regimental Conduct Sheet.....
- Compulsory Stoppages.....
- Casualty Forms.....
- Proceedings on discharge.....
- Corps History Sheet.....
- Date and No. of Deposit Receipt for Purchase Money and Amount.....
- Parchment Certificate.....
- Medical Report for Invalids.....
- Medical History Sheet.....
- Proceedings of Regt. Court Martial.....
- Copies of Convictions by Civil Power.....
- Company Conduct Sheet.....
- Clothing Transfer Certificate.....
- Inventory of Kit.....
- Last Pay Certificate.....

DISCHARGE I TS

R. O. No.....  
H. Q. No.....

Name, **COCHRANE** EDWARD SAM.  
 Regt. No., **59174** Rank. *pte.*  
 Corps. **21st. Batt. I.E.F.**

*Killed in Action 15/11-9-16.* 26651

- Index Card.....
- Casualty Card.....
- Non-Effective Card.....
- Part II Order Card.....
- Change of Address Card.....
- Honour & Award Card.....



*Meds 610*

A.F.B. 122 — 1 221,1237-2  
 A.F.B. 178 — 1 220,181-1  
 Cas cards - 2 1242

4  
 23-19  
 15-19  
 11-19

*mx*  
*23/1/20*



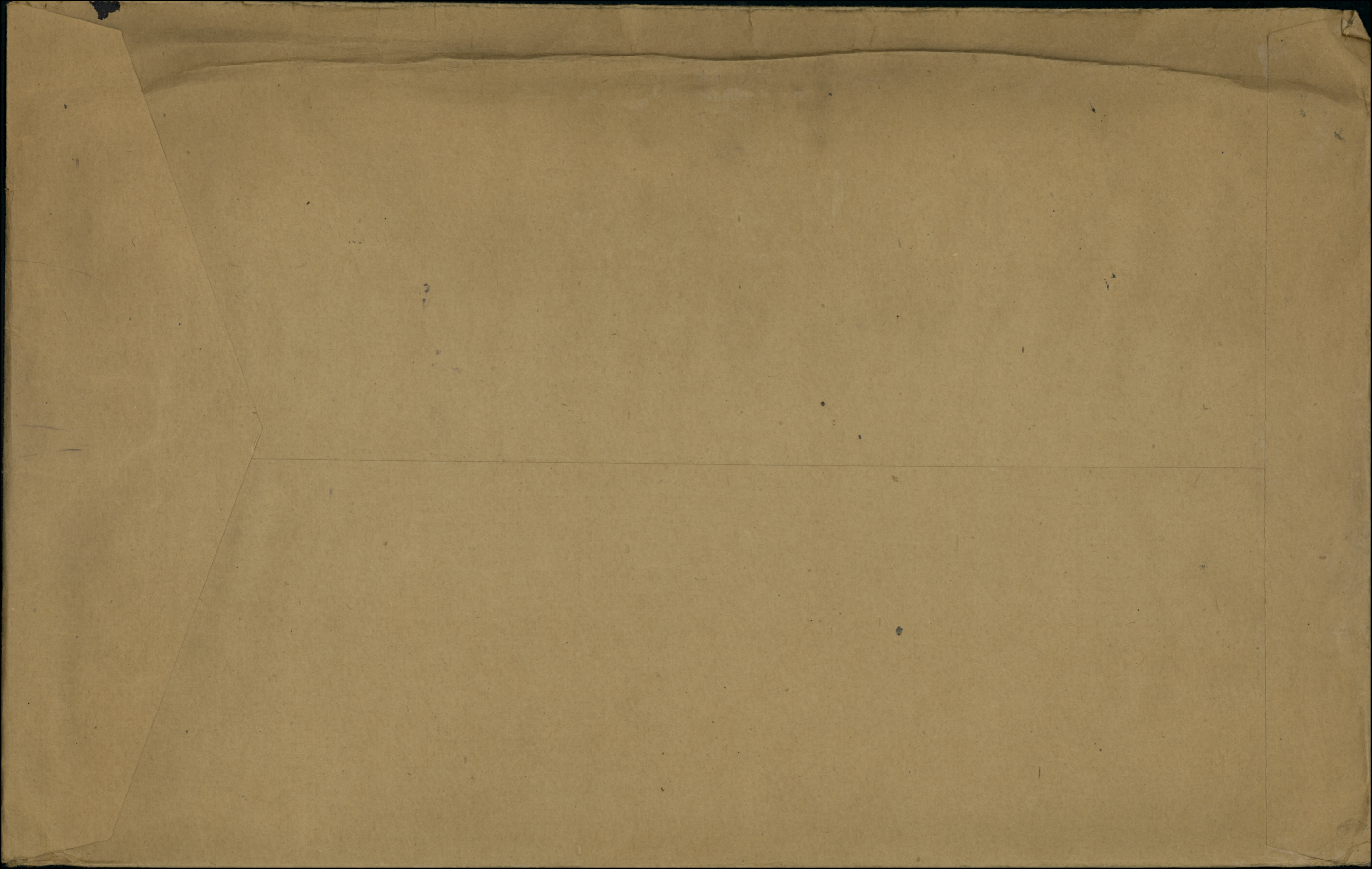



287

59174

ATTESTATION PAPER.

No.

Folio.

CANADIAN OVER-SEAS EXPEDITIONARY FORCE.

QUESTIONS TO BE PUT BEFORE ATTESTATION.

(ANSWERS).

- 1. What is your name?..... Edward S. Cochran
  - 2. In what Town, Township or Parish, and in what Country were you born?..... Cleveland, Ohio U.S.A.
  - 3. What is the name of your next-of-kin?..... Wm. J. Cochran
  - 4. What is the address of your next-of-kin?..... Grafton, Ont
  - 5. What is the date of your birth?..... 12 Feb. 1896
  - 6. What is your Trade or Calling?..... Farmer
  - 7. Are you married?..... No
  - 8. Are you willing to be vaccinated or re-vaccinated?..... Yes
  - 9. Do you now belong to the Active Militia?..... No
  - 10. Have you ever served in any Military Force?..... No  
If so, state particulars of former Service.
  - 11. Do you understand the nature and terms of your engagement?..... Yes
  - 12. Are you willing to be attested to serve in the CANADIAN OVER-SEAS EXPEDITIONARY FORCE?..... Yes
- ..... E. S. Cochran (Signature of Man).  
 ..... A. J. Jones (Signature of Witness).

DECLARATION TO BE MADE BY MAN ON ATTESTATION.

I, Edward S. Cochran, do solemnly declare that the above answers made by me to the above questions are true, and that I am willing to fulfil the engagements by me now made, and I hereby engage and agree to serve in the Canadian Over-Seas Expeditionary Force, and to be attached to any arm of the service therein, for the term of one year, or during the war now existing between Great Britain and Germany should that war last longer than one year, and for six months after the termination of that war provided His Majesty should so long require my services, or until legally discharged.

..... E. S. Cochran (Signature of Recruit)  
 Date..... 3-11- 1914. .... A. J. Jones (Signature of Witness)

OATH TO BE TAKEN BY MAN ON ATTESTATION.

I, Edward S. Cochran, do make Oath, that I will be faithful and bear true Allegiance to His Majesty King George the Fifth, His Heirs and Successors, and that I will as in duty bound honestly and faithfully defend His Majesty, His Heirs and Successors, in Person, Crown and Dignity, against all enemies, and will observe and obey all orders of His Majesty, His Heirs and Successors, and of all the Generals and Officers set over me. So help me God.

..... E. S. Cochran (Signature of Recruit)  
 Date..... 3-11- 1914. .... A. J. Jones (Signature of Witness)

CERTIFICATE OF MAGISTRATE.

The Recruit above-named was cautioned by me that if he made any false answer to any of the above questions he would be liable to be punished as provided in the Army Act.  
 The above questions were then read to the Recruit in my presence.

I have taken care that he understands each question, and that his answer to each question has been duly entered as replied to, and the said Recruit has made and signed the declaration and taken the oath before me, at..... Kingston..... this..... 3..... day of..... Nov...... 1914.

..... W. S. Hughes (Signature of Justice)

I certify that the above is a true copy of the Attestation of the above-named Recruit.

..... W. S. Hughes (Approving Officer)  
 ..... H. Col.

Colony 27.10.14



Description of Edward Sam Cochrane on Enlistment.

Apparent Age 18 years 10 months.  
 (To be determined according to the instructions given in the Regulations for Army Medical Services.)

Distinctive marks, and marks indicating congenital peculiarities or previous disease.

(Should the Medical Officer be of opinion that the recruit has served before, he will, unless the man acknowledges to any previous service, attach a slip to that effect, for the information of the Approving Officer.)

Height 5 ft. 8 3/4 ins.

Chest measurement { Girth when fully expanded 37 ins.  
 Range of expansion 3 ins.

Complexion Fair

Eyes brown

Hair brown

Religious denominations { Church of England  
 Presbyterian  
 Wesleyan  
 Baptist or Congregationalist  
 Other Protestants Methodist  
 (Denomination to be stated.)  
 Roman Catholic  
 Jewish

Scar back of right thigh.  
 Mole on right side of chest  
 & small scar on point of right shoulder  
 Scar point of left elbow.

CERTIFICATE OF MEDICAL EXAMINATION.

I have examined the above-named Recruit and find that he does not present any of the causes of rejection specified in the Regulations for Army Medical Services.

He can see at the required distance with either eye; his heart and lungs are healthy; he has the free use of his joints and limbs, and he declares that he is not subject to fits of any description.

I consider him\* fit for the Canadian Over-Seas Expeditionary Force.

Date Nov 3 1914.

Place Hungston

G. M. G. May, 14<sup>th</sup>  
 Medical Officer.

\*Insert here "fit" or "unfit."

NOTE.—Should the Medical Officer consider the Recruit unfit, he will fill in the foregoing Certificate only in the case of those who have been attested, and will briefly state below the cause of unfitness:—

.....  
 .....  
 .....

CERTIFICATE OF OFFICER COMMANDING UNIT.

E. S. Cochrane having been finally approved and inspected by me this day, and his Name, Age, Date of Attestation, and every prescribed particular having been recorded, I certify that I am satisfied with the correctness of this Attestation.

W. S. Hughes (Signature of Officer)  
St. Col.

Date 3/11 1914.



257

# ATTESTATION PAPER.

No. 59174

## CANADIAN OVER-SEAS EXPEDITIONARY FORCE.

Folio.

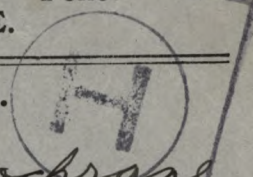

### QUESTIONS TO BE PUT BEFORE ATTESTATION.

(ANSWERS).

1. What is your name?..... Edward L. Cochrane
2. In what Town, Township or Parish, and in what Country were you born?..... Cleveland, Ohio, USA
3. What is the name of your next-of-kin?..... Mrs J. F. Cochrane
4. What is the address of your next-of-kin?..... Napton Ont
5. What is the date of your birth?..... 13 Febry 1896
6. What is your Trade or Calling?..... Farmer
7. Are you married?..... No
8. Are you willing to be vaccinated or re-vaccinated?..... Yes
9. Do you now belong to the Active Militia?..... No
10. Have you ever served in any Military Force?..... No  
If so, state particulars of former Service.
11. Do you understand the nature and terms of your engagement?..... Yes
12. Are you willing to be attested to serve in the CANADIAN OVER-SEAS EXPEDITIONARY FORCE?..... Yes

Edward L. Cochrane.....(Signature of Man).  
 J. F. Jones.....(Signature of Witness).

### DECLARATION TO BE MADE BY MAN ON ATTESTATION.

I, Edward Cochrane, do solemnly declare that the above answers made by me to the above questions are true, and that I am willing to fulfil the engagements by me now made, and I hereby engage and agree to serve in the Canadian Over-Seas Expeditionary Force, and to be attached to any arm of the service therein, for the term of one year, or during the war now existing between Great Britain and Germany should that war last longer than one year, and for six months after the termination of that war provided His Majesty should so long require my services, or until legally discharged.

Date Nov 5<sup>th</sup>, 1914. } E. L. Cochrane.....(Signature of Recruit)  
 } J. F. Jones.....(Signature of Witness)

### OATH TO BE TAKEN BY MAN ON ATTESTATION.

I, Edward Cochrane, do make Oath, that I will be faithful and bear true Allegiance to His Majesty King George the Fifth, His Heirs and Successors, and that I will as in duty bound honestly and faithfully defend His Majesty, His Heirs and Successors, in Person, Crown and Dignity, against all enemies, and will observe and obey all orders of His Majesty, His Heirs and Successors, and of all the Generals and Officers set over me. So help me God.

Date Nov 5<sup>th</sup>, 1914. } E. L. Cochrane.....(Signature of Recruit)  
 } J. F. Jones.....(Signature of Witness)

### CERTIFICATE OF MAGISTRATE.

The Recruit above-named was cautioned by me that if he made any false answer to any of the above questions he would be liable to be punished as provided in the Army Act.  
 The above questions were then read to the Recruit in my presence.

I have taken care that he understands each question, and that his answer to each question has been fully entered as replied to, and the said Recruit has made and signed the declaration and taken the oath before me, at Napton this 5 day of Nov, 1914.

W. S. Hughes.....(Signature of Justice)

I certify that the above is a true copy of the Attestation of the above-named Recruit.

W. S. Hughes.....(Approving Officer)

WB



Description of Edward Sam Cochrane on Enlistment.

Apparent Age 18 years 10 months.  
 (To be determined according to the instructions given in the Regulations for Army Medical Services.)

Height 5 ft. 8 3/4 ins.

Girth when fully expanded 34 ins.  
 Range of expansion 3 ins.

Complexion Fair

Eyes Brown

Hair Brown

Religious denominations.  
 Church of England.....  
 Presbyterian.....  
 Wesleyan.....  
 Baptist or Congregationalist.....  
 Other Protestants Methodist  
 (Denomination to be stated.)  
 Roman Catholic.....  
 Jewish.....

Distinctive marks, and marks indicating congenital peculiarities or previous disease.

(Should the Medical Officer be of opinion that the recruit has served before, he will, unless the man acknowledges to any previous service, attach a slip to that effect, for the information of the Approving Officer.)

Scar back of right thigh.  
 Wound on right side of chest  
 2 small scars on point of right shoulder.  
 Scar point of right elbow.

CERTIFICATE OF MEDICAL EXAMINATION.

I have examined the above-named Recruit and find that he does not present any of the causes of rejection specified in the Regulations for Army Medical Services.

He can see at the required distance with either eye; his heart and lungs are healthy; he has the free use of his joints and limbs, and he declares that he is not subject to fits of any description.

I consider him\* fit for the Canadian Over Seas Expeditionary Force.

Date Nov 5 14 1914.

Place Kingston

*[Signature]*  
 Medical Officer.

\*Insert here "fit" or "unfit."

NOTE.—Should the Medical Officer consider the Recruit unfit, he will fill in the foregoing Certificate only in the case of those who have been tested, and will briefly state below the cause of unfitness:—

CERTIFICATE OF OFFICER COMMANDING UNIT.

E. S. Cochrane having been finally approved and inspected by me this day, and his Name, Age, Date of Attestation, and every prescribed particular having been recorded, I certify that I am satisfied with the correctness of this Attestation.

*[Signature]*  
 (Signature of Officer)

Date Nov 20 14 1914.



Name *Edward Sam.* Cochrane, ~~S.~~ Rank ~~S.~~ *L/CPL*

Reg. No. 59174.

Unit 21st. Battn.

Next of Kin Canada.

L25. C. 1829

Date	Movement	Place	Casualty	List No.	Notified N/K O.	W.O. List
14-7-15.	Can. Con. Hosp.	Monks Horton.	Pneumonia	26		
5-9-15.	"	"Dis. to Duty.	"	29		
8-4-16.	No. 18. Gen.	Camiers.	GSW. R. Knee.	A198	<sup>m</sup> 5342	18-4-16
16-4-16.	No. 6. Conv Depot.	Etaples.	do	A206		
4-5-16.	PROCEEDING TO JOIN UNIT.		do	A218		
6-5-16.	REJOINED UNIT.		do	A226		
21-6-16.	No. 5. Fld Amb.	GSW. 3rd. Fing L	Hand.	A267	<sup>m</sup> 9671	13-7-16
21-6-16.	No. 4. Can Fld Amb.	do	do	A267		
24-6-16.	DISCHARGED TO DUTY.		do	A275		
2-7-16.	REJOINED UNIT.		do	A292		
15th to 17th-9-16.	REPORTED FROM BASE)					
	KILLED IN ACTION.			A335	<sup>o</sup> 2153	5-10-16











Date	Movement	Place	Casualty	List No.	Notified N/KO.	W.O. List
1918.	Now Transferred to Bayreuth, Bayern.	Bayreuth, Bayern.	A/84 Q146	S.60.		
28.12	Died at. <del>Le</del> Combro	No. 25. Montbeliard, Doubs	A/12	Q183	6091	
Ref. A/12	d/6-1-19	Cas history to be amended to read as above please				
"	"	"	Casualty now stated to be "died of Grippe"		PW. 883	
Ref A/21	d/17-1-19	It is now stated above Soldier was		A/476	H632	166408 90491
"Released Prisoner of War" and Died 25-12-18 in		French Hospital, Complementaire 25, Secteur Postal 128, of "Pneumonia"		<del>Q183</del> 473		



*Wae*  
Number

59174

Rank

L/Cpl

Surname

COCHRANE

Christian Names

Edward Samuel

Unit

21st Bn Can Inf Theatre of War France

Date of Service

14-9-15

Remarks

Father

Latest Address

J. F. Cochrane Esq.

"The Cedars"

Grafton Ont.

Roll No.

*B*  
Page 2125

21st Bn



G. 12751 Day

APR 16 1921

G. A 39004 Day

APR 16 1921



H.A.S.

649-C-2467.

Cochrane, E.S. L/Cpl. #59174-C.E.F. *21st. Div.*

Medals  
& Dec. (father)

J.F. Cochrane, Esq.,  
"The Cedars,"  
Grafton, Ont.

Scroll Desp. ~~DEC 15 1920~~ Reqn. No. *75060*

Plaque Desp. ~~DEC 6 1921~~ Reqn. No. *P19528*

P. & S. (father)

ditto

*(Serial no. 760918.)*

Mem. Cross. (mother)

Mrs. J.F. Cochrane,  
(Address as above).

*E. lig. for star. Pte. 21st. Div*  
*" U.M.*  
*" B.W.M.*  
*m.t.*

34314

*Decp. 11/11/20 (m) C. 30148*

*B2*



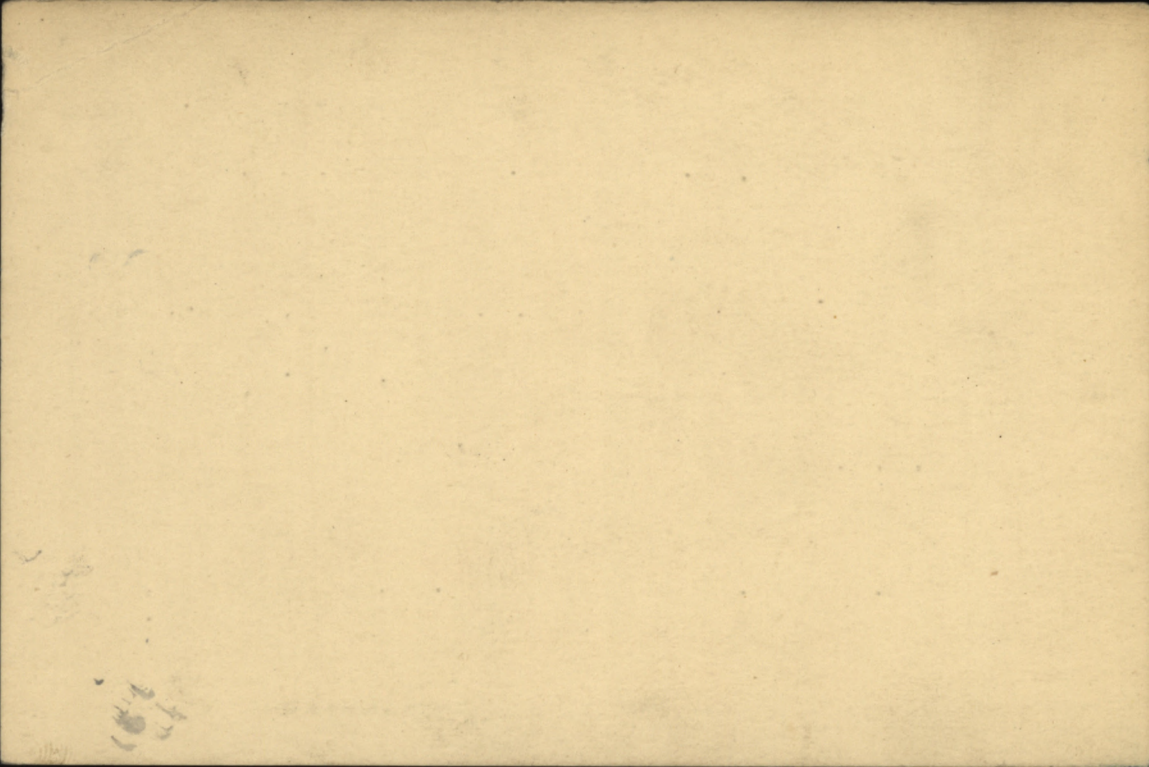



(644-C-2467)

CARD NO.

SURNAME.

Cochrane

CHRISTIAN NAMES

Edward J.

REGL. No. 59174

RANK

pte.

UNIT 21st

Batt.

FORMER CORPS

Nil.

W/B

D  
FOLL.

old No.  
59287

NEXT OF KIN.

CHANGE OF ADDRESS

NAMES IN FULL

Cochrane, Mrs. J. J.

RELATIONSHIP TO SOLDIER

W. F. S.

ADDRESS

Grafton, Ont.

COUNTRY OF BIRTH

U.S.A., Cleveland

DATE

Feb. 13/96.

PLACE OF ATTESTATION

Kingston, Ont.

DATE

Nov. 5-14.

Sailed from Montreal Per. S.S. "Meta-gamma" 6-5-15  $\frac{68}{3}$



MARRIED

SINGLE

WIDOWER

TRADE OR CALLING

Farmer *yes.*

RELIGION

Methodist

DESCRIPTION.

APPARENT AGE

18 YEARS

10 MONTHS

HEIGHT

5 FEET

8  $\frac{3}{4}$  INCHES

CHEST MEASUREMENT

34 INCHES

EXPANSION

3 INCHES

COMPLEXION

*Fair*

EYES

*brown*

HAIR

*brown*

DISTINGUISHING MARKS

*scar back of r. thigh - mole on r. side chest - 2 small scars - pt. of r. shoulder. scar pt. r. elbow.*

MEDICAL EXAMINATION.

PLACE

*Kingston, Ont.*

DATE

*Nov. 5<sup>th</sup> 1914*

*Present Address not stated*



No. 284  
 59174 May pay list

RANK. Pte

NAME Cochrane C S

T. O. S.

UNIT 21st Battalion  
 (2nd O/S Contingent)

M. D. 3

PAID FROM		PAID TO		SIG. OR REC'T	PROMOTIONS, TRANSFERS, DISCHARGES, ETC.	
1914		1915			PARTICULARS	AUTHORITY
Nov	11	Nov	30	O.S.		
		Dec		✓		
1915	Jan	Jan	1915	✓		
	Feb.			O.S.		
	Mar.			✓		
	Apr.			✓		
	May			✓		
					1 day forfeiture of pay.	S.O. 115 of 27-3-15.

UNIT SAILED  
 MAY 20 1915







MOORE BARRACKS, CANADIAN HOSPITAL, SHORNCLIFFE.

ADMITTING CARD.

Regt. No. 59174 A. & D. No. 1121  
Rank Pte  
Name Cochrane - Edward.  
Corps 21 ton - B. Co - Service 4/12.  
Religion Methodist Age 19.  
M. H. Rec'd 12.6.15. M. H. Requested M. H. Ret'd 14.7.15  
Disease Pneumonia  
Admitted June 11/15  
Discharged  
Place in Hospital Ward 14  
Transferred Monks Horton 14.7.15  
Results



REMARKS:



Surname

Christian Name or Names

Reg. No.

Cochrane E.

S. 59174

Rank

Unit

Co.

Troop

Batty.

Pte. 21 Btn.

Hospital

Date of Admission

Transferred

Monks Horton 600. Hosp. 14. 7. 15.

18 Gen Bamiers Hosp. 8. 4. 16

~~Reading~~ Hosp. ~~11. 11. 15~~

6 Gen Depot Etaples Hosp. 16. 4. 16

Diagnosis

Pneumonia.

(1)

Later Diagnosis (if changed)

(2)

G. S. W. right knee (alt)

(3)

G. S. W. 3 fingers L. hand.

Additional Diagnoses, if more than one state present

Killed in Action

15/4 9-16

DISPOSITION

To Duty

Date

24-6-16

REMARKS

9. R. 5. 8. 15. fit for duty

6. 2. 18. 4. 16 a 198

" 28. 4. 16 a 206

Ch. 13. 5. 16 a 18-2

Ch. 24. 5. 16 a 216-2

" 13. 7. 16. A 267

e. l. 24-7-16 A 275.

" 14. 8. 16 a 292

5. 10. 16 A 355

Discharged 5. 9. 15 -  
of 403 G. B. D. reports

Proceeding to join unit  
4. 5. 16

of 21 Bn reports  
Rejoined unit 6. 5. 16

A.M.D. 2 DEPT. 7. 16

Bch. of D.G.M.S. O.M.F.C. London.

RW



EPITOME OF HOSPITAL TREATMENT.

Hospital

Adm.

- | 1. | Hospital                 | Adm.                 |
|----|--------------------------|----------------------|
| 1. | S. C. F. Amb.<br>4 " " " | 21.6.16.<br>21.6.16. |
| 2. |                          |                      |
| 3. |                          |                      |
| 4. |                          |                      |
| 5. |                          |                      |
| 6. |                          |                      |
| 7. |                          |                      |



CERTIFIED CORRECT.  
Army Form B. 103.  
Canadian Record Office,  
Westminster House,  
2, Millbank, S.W.

Casualty Form—Active Service.

Regiment or Corps 21st Battalion

Regimental No. 59174 Rank Private Name Cochran E. S.

Enlisted (a) 29-10-14 Terms of Service (a) Duration of war Service reckons from (a) 29-10-14

Date of promotion to present rank } Date of appointment to lance rank } Numerical position on roll of N.C.Os. }

Extended \_\_\_\_\_ Re-engaged \_\_\_\_\_ Qualification (b) \_\_\_\_\_

Report		Record of promotions, reductions, transfers, casualties, etc., during active service, as reported on Army Form B. 213, Army Form A. 36, or in other official documents. The authority to be quoted in each case.	Place	Date	Remarks taken from Army Form B. 213, Army Form A. 36, or other official documents.
Date	From whom received				

		Disembarked	Boulogne	SEP 14 1915	
2. 10. 15	Of. 21 Bn	awarded 2 days F.P. II for absent from C.O. post	Dranouville	2. 10. 15	B. 2069 2. 10. 15
8/4	18 feu	S.S. W knee R	18 feu H	8/4	2024 8/4/16
9/4	17 CCS	do	at. to Base	7/4	2026 9/4 Dec 117
16/4	18 feu.	S.S.W. leg (R) flesh Ser	6 Can Dep	16/4	2034 16/4
9/4	6 CBA	S.S.W. Sh R knee	6 C.S.	7/4	2036 9/4 " 125-
6/5	Can Base	proceeded to join	unit -	4/5	107/307/3/309 127
22/4	do	taken on strength from 1st Bn A.	Can Base	21/4	- - - - 304 128
	37 Bn	Joined	unit -	6/5	213 6/5 132
	5th CFA.	SW. 3rd finger rt. hand - to	4th C.F.A.	21/6	A36-25/6. D.C.S. 157-8/7.
	21st Bn.	appointed Lt Cpl. on pay	unit	26/5	1810 No. 26 30/6.
	4th CFA.	SW. 3rd finger rt. hand - to	Duty.	24/6	A36. 24/6 - D.C.S. 164 18/7.
	21st Bn	at duty from hospital	unit	2/7	A213-28/7 " 1179 9/8
	Do	appt. Lt Cpl. vice Wilson	Do.	26/5	1810 No. 26 2/30.6.16.

(a) In the case of a man who has re-engaged for, or enlisted into Section D, Army Reserve, particulars of such re-engagement or enlistment will be entered.  
(b) e.g., Signaller, Shoeing Smith, etc., etc., also special qualifications in technical Corps duties. [P.T.O.]



59174

L/Cpl. Cochrane, E. S.

Report		Record of promotions, reductions, transfers, casualties, etc., during active service, as reported on Army Form B. 213, Army Form A. 36, or in other official documents. The authority to be quoted in each case.	Place	Date	Remarks taken from Army Form B. 213, Army Form A. 36, or other official documents.
Date	From whom received				
22/9	21st Bn.	Killed in action	In the Field	Sep. 15-17 1916.	B 213. 1810 No. 53 <sup>3/4</sup> . OCS 208 <sup>30/4</sup> .  J. Whogau Capt. For Officer i/c Can. Records, Canadian Section. G.H.Q. 3rd Echelon.



326  
226

**DUPLICATE.**

Army Form B. 178.

**To be used for recruits enlisting direct into the Regular Army only.  
Army Form B. 178<sup>A</sup> to be used for Special Reserve recruits and  
Special Reservists enlisting into the Regular Army.**

**MEDICAL HISTORY of**

Surname COCHRANE Christian Name Edward Sam.

TABLE I.—GENERAL TABLE.

Birthplace ... Parish Cleveland County Ohio, U.S.A.

Examined ... { on 5th day of Novbr. 1914 .  
at Kingston

Declared Age ... 18 years 10 mths days.

Trade or Occupation ... Farmer

Height ... 5 feet, 8 $\frac{3}{4}$  inches.

Weight ... lbs.

Chest Measurement { Girth when fully Expanded. 34 37. inches.  
Range of Expansion 3 inches.

Physical Development ... Good.

Vaccination Marks { Arm ... Right Left  
Number

When Vaccinated ... Never

Vision ... { R.E.—V=  
L.E.—V=

(a) Marks indicating congenital peculiarities or previous disease ...

(b) Slight defects but not sufficient to cause rejection ... 2 defective teeth

Approved by (Signature) G. W. Mylls,  
(Rank) Maj. 14th Medical Officer.

Enlisted ... { at Kingston  
on 3rd day of Novbr. 1914 .

Joined on Enlistment	Corps.	Regtl. No.
	<u>21st Battalion</u>	<u>5 9 1 7 4</u>
Transferred to		

Became non-effective by  
on \_\_\_\_\_ day of \_\_\_\_\_ 191 .

(Signature)  
(Rank)

This Medical History Sheet has been compared with the Corresponding Attestation Paper, and entries made in red have been taken from the Attestation Paper.

Certify the foregoing to be a true copy of an original entry on a Medical History Sheet  
 For the Officer in Charge of Records  
 Canadian Contingents  
 W. R. Ward







**Table II.—Only for Admissions to Hospital or to the Sick**

Name of Hospital	Admitted to Hospital			Discharged from Hospital			Disease	Number of Days in Hospital	Remarks
	Day	Month	Year	Day	Month	Year			
M. B. Can. Hosp.	11	6	15	14	7	15	Pneumonia	34	
Can. Con. Hosp.	14	7	15	4	9	15			Repo
Monks Horton Nr.									7/6
Hythe Kent									Ho
No. 18. Gen Hos. Carn.				16	4	16	G. S. W. rt Knee		No
No. 6. Can. Depot.	16	4	16	4	5	16	do	18	
No. 3. Gen. Base Depot.	4	5	16	6	5	16	do	2	
No 5 Can. Pd. Amb.	21	6	16	21	6	16	G. S. W. 3 <sup>rd</sup> Finger, Lt. Hand	1	
No 4 " " "	21	6	16	24	6	16	" " "	3	



**al or to the Sick List in the Case of Warrant Officers treated in quarters.**

Number of Days in Hospital	Remarks bearing on the cause, nature, or treatment of the case, likely to be of interest or of future use. In cases of syphilis, admissions and re-admissions to hospital will be shown. The subsequent progress, including particulars of treatment out of hospital, transfers, &c., will be given in the special syphilis case sheet.	Signature of Medical Officer.
34	Transferred to Convalescent Home.	A. F. MacAuley. Capt.
	Reported sick at Sandling Camp.	
	7/6/15 Admitted to Moore Bks. Hosp. 1 month. C.I.C.H. Monks. Horton. No. debility Fit for duty.	Thos Lyon.
	To No.6. <b>Can.</b> Depot.	A 206
18	To No.3 Gen Base Depot.	A 218
2	Rejoined Unit.	A 226
Hand	1	A267
	3	A275.
	D to D	



1121

MEDICAL CASE SHEET.\*

No. in  
Admission  
and  
Discharge  
Book.

Regimental No.

Rank.

Surname.

Christian Name.

59174

Pte

Cochran

Edward

Unit.

Age.

Service.

21st Batt. B. Coy

19.

6  
12.

112  
Year  
1915

Station  
and Date

Disease.

Pneumonia

Complaint. Pain in side and headache.

FAMILY HISTORY. Negative

Previous illness and injury. Had mumps in childhood. Had pneumonia last winter. was sick for three weeks.

Present Illness. Had chill on 9/6/15 complains of pain on right side and pain is most severe when patient takes a deep breath or coughs, patient has headache.

Physical Examination.

Herpes on lips. Cough.

~~Thorax~~ Rals blowing, breathing, consolidation L + R. Dyspnoea.

Transferred to Convalescent Home

A. J. Macaulay Capt

\*The first and last entries will be signed, and transfers from one Medical Officer to another, attested by their signatures.







# CLINICAL CHART.

Army Form B. 181.

Corps 21<sup>st</sup> Batt.

(To be attached to Case Sheet.)

Military Hospital James Barracks.

No. 59172

Rank and Name Cochrane-Edward. Pte.

Age 19

Service 6/12

Disease \_\_\_\_\_

Date of admission June 11<sup>th</sup> '15

Date of discharge \_\_\_\_\_

Result \_\_\_\_\_

Dates of Observation	June																												July				
	19	12	13	14	15	16	17	18	19	20	21	22	23	24	25	26	27	28	29	30	July 1	2	3	4	5	6	7	8					
Days of Disease	1	2	3	4	5	6	7	8	9	10	11	12	13	14	15	16	17	18	19	20	21	22	23	24	25	26	27	28					
Temperature Fahrenheit	Time	Time	Time	Time	Time	Time	Time	Time	Time	Time	Time	Time	Time	Time	Time	Time	Time	Time	Time	Time	Time	Time	Time	Time	Time	Time	Time	Time					
	A.M.P.M.	A.M.P.M.	A.M.P.M.	A.M.P.M.	A.M.P.M.	A.M.P.M.	A.M.P.M.	A.M.P.M.	A.M.P.M.	A.M.P.M.	A.M.P.M.	A.M.P.M.	A.M.P.M.	A.M.P.M.	A.M.P.M.	A.M.P.M.	A.M.P.M.	A.M.P.M.	A.M.P.M.	A.M.P.M.	A.M.P.M.	A.M.P.M.	A.M.P.M.	A.M.P.M.	A.M.P.M.	A.M.P.M.	A.M.P.M.	A.M.P.M.					
107°																																	
106°																																	
105°																																	
104°																																	
103°																																	
102°																																	
101°																																	
100°																																	
99°																																	
98°																																	
97°																																	
Pulse per Minute	80	80		78		80	79	76		80	82	82	84	82	82	80		78		96	112	90	89	89		108							
Respirations per Minute	22	24		20		22	20	30		28	26	28	26	24	26	26				24	48	40	20	21		40							
Motions per 24 hours																																	

Signature \_\_\_\_\_

In charge of case.



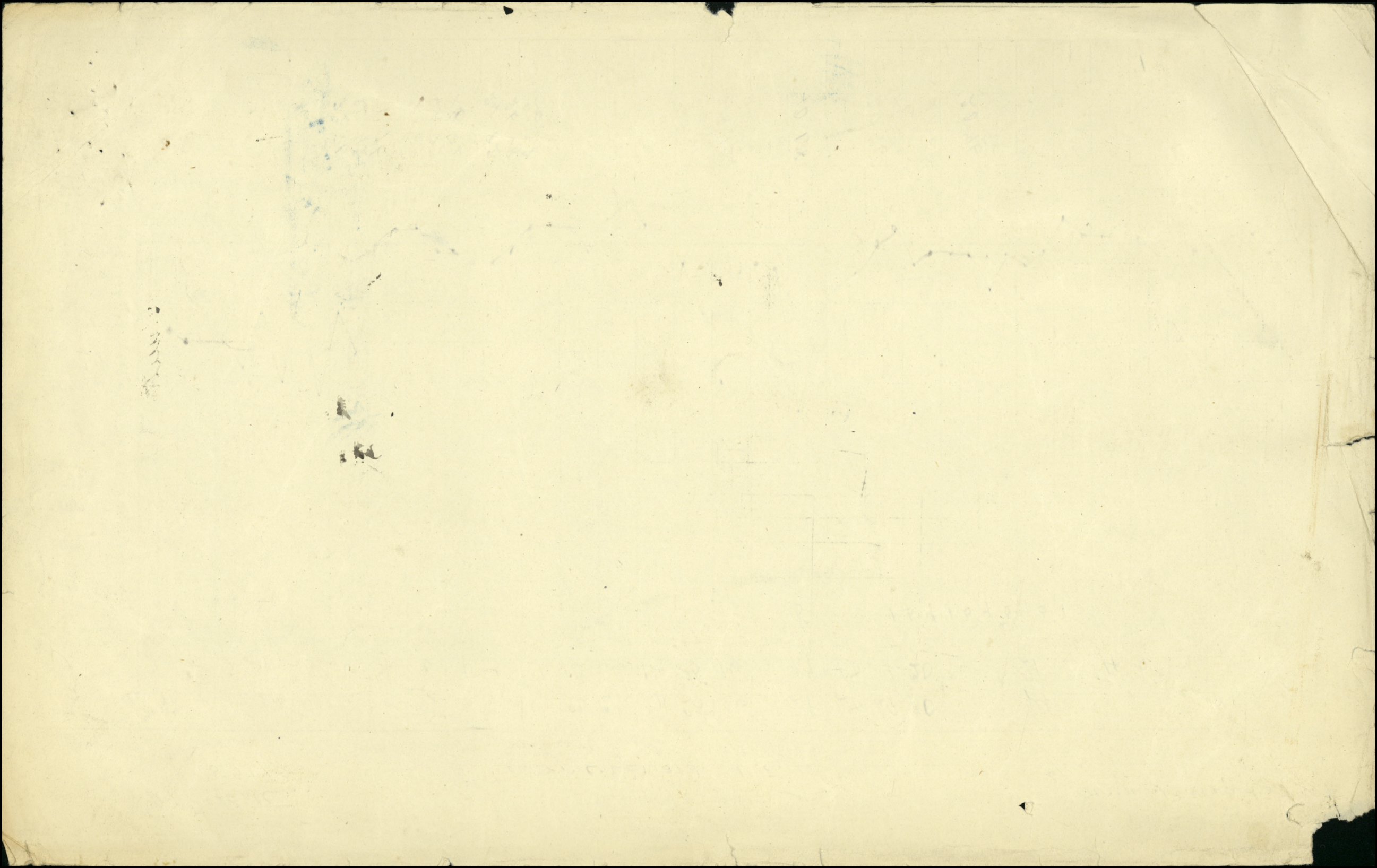



June 29<sup>th</sup>, 1915

# Kindly examine sputum from  
59174 Pte Cochran and oblige. There are  
not any Laboratory reports (Examination Bed)  
procured at present

No T.B. found  
James H. Howell  
James Roberts Capt  
Ward 16.



*[Faint, illegible handwriting, likely bleed-through from the reverse side of the page.]*



see card 2

NAME

*Cochrane Edward Sam*

H. Q. FILE No. 649-

REG'TL. No. 59174.

RANK AND CORPS

*pt. Lt. Cpl. 21st. B. Battalion*

CABLE

NATURE OF CASUALTY

NO. *1489*  
FOLL. *X*

NO.

DATE

<i>175342</i>	<i>17-4-16</i>	<i>Adm to No 18 Gen Hosp. Camiers, April 8th. G. S. W. Knee, slight.</i>
<i>179671</i>	<i>12-7-16</i>	<i>admt to No 5 Field Amb. June 21st 1916 G.S.W. hand. v</i>
<i>02153</i>	<i>5-10-16</i>	<i>Killed in Action between <sup>Bps</sup> 15<sup>th</sup> + 17<sup>th</sup> / 16</i>
<i>2090.</i>	<i>30-9-16</i>	<i>" " " " " "</i>
	<i>Rowe</i>	



LIST No.

HOSPITAL

DATE OF  
ADMISSION

REMARKS

A 335 Rep. from Base 15/17-9-16 Killed in Action



LIST No.

HOSPITAL

DATE OF  
ADMISSION

REMARKS

LIST No.	HOSPITAL	DATE OF ADMISSION	REMARKS
26.	Can. Conv. Monks Horton.	14-7-15	Pneumonia
✓ <del>29</del> 30	Can. Conv. Monks Horton	5-9-15	Disch. - Fit for Duty.
a 198	No 18 Gen. Carriers	8-4-16	Gsw. Rt knee Sgt.
a 206	No 6 Conv. Depot Etaples	16-4-16	" " " " " "
a 218	D. Co No 3 Gen. Base Depot Repts.	4-5-16	" " " " " "
a 226	D. Co 21 <sup>st</sup> Gen. Depo.	6-5-16	Proceeding to join unit. Rej unit GSW Rt knee
a 267.	No 5 Can. Fd. Amb.	21-6-16.	Gsw. 3rd fingers
a 267.	Ex No 4 " " " "	21-6-16.	Gsw. 3rd Finger.
u. 275.	Disch to duty	<del>24-6-16</del>	" " " " " " L. Hand
a. 292.	Rep from Base	2-7-16.	" " " " " " Rej unit



*see card 1*

H. Q. FILE No. 649-

REG'T'L. No. **59174**

NAME **Cochrane Edward Sam**

RANK AND CORPS **L/Cpl. 21st Bn.**

CABLE

NO.

DATE

NATURE OF CASUALTY



Examined { on 5 day of Nov 1914  
 at Kingston  
 Birthplace { City or Town Cleveland Ohio  
 County Ohio

Approved by [Signature]  
 Rank 1st Lt M.O.

Apparent age 18 yr 10 mo  
 Trade or occupation Farmer  
 Height 5 Feet 8 3/4 Inches.  
 Weight \_\_\_\_\_ Lbs.  
 Chest measurement { Minimum 34 inches.  
 Maximum expansion 3 inches.  
 Physical development Good  
 Small-Pox Marks None

Date	Fit or Unfit	EXAMINED FOR RE-ENGAGEMENT,
		M.O.
		M.O.
		M.O.
		M.O.
		M.O.
		M.O.
		M.O.

Vaccination Marks { Arm Right Left  
 Number None

Date	Result	VACCINATIONS.
<u>6/15</u>	<u> </u>	<u>J. E. Ellington Maj A.M.O.</u>
		M.O.
		M.O.

(a) Marks indicating congenital peculiarities or previous disease \_\_\_\_\_  
 (b) Slight defects but not sufficient to cause rejection  
2 defective teeth

Date	Result	ANTI-TYPHOID INOCULATIONS, ETC.
<u>10/11/14</u>	<u> </u>	<u>W. E. Ellington Maj A.M.O.</u>
<u>2/11/14</u>	<u> </u>	<u>W. E. Ellington Maj A.M.O.</u>
		M.O.

Enlisted on 3 day of Nov 1914 at Kingston

	CORPS.	REG'TL NUMBER.	HABITS.	DATE.
Joined on enlistment	<u>21st Bn.</u>	<u>59174</u>		
Transferred to.. ..	<u>B.</u>			

EXAMINED OR DISCHARGED BY A MEDICAL BOARD.

STATION.	DATE.	DISEASE.	RESULT.

N. B.—This sheet to be disposed of in accordance with instructions in the Regulations for Army Medical Service, on the man becoming non-effective; the date and cause being stated on next page.



CANADIAN CONVALESCENT HOSPITAL  
MONKS HORTON, NEAR HYTHE, KENT.

Christian Name

Surname

STATION.	Date of Arrival at the Station.	DATES OF						DISEASE.	Number of days in Hospital.	Remarks on nature of the disease : how induced : if mild or severe : if completely recovered from ; whether any particular treatment was adopted. In venereal cases state nature of primary disease, and whether mercury has been given. If an accident, state whether it occurred on duty and whether a Court of inquiry was held. Date of issue and particulars of artificial teeth or surgical appliances supplied. Particulars of prophylactic inoculations.	Signature of Medical Officer.
		Admission into Hospital.			Discharge from Hospital.						
		Day	Month	Year	Day	Month	Year				
<i>in B Can Hosp</i>		<i>11</i>	<i>6</i>	<i>15</i>	<i>14</i>	<i>7</i>	<i>15</i>	<i>Pneumonia</i>	<i>34</i>	<i>Transferred to Convalescent Home</i>	<i>W Macaulay Esq</i>
		<i>14</i>	<i>7</i>	<i>15</i>	<i>4</i>	<i>9</i>	<i>15</i>			<i>Reported sick at Sandling Camp 7/6/15. Admitted to Moore Bar Can H. (one month) - C.C.H. Monks Horton no disability. fit for duty</i>	<i>Thos Lynn</i>
<i>No 18 Gen Hosp Carriers</i>					<i>16</i>	<i>4</i>	<i>16</i>	<i>GS Wrt knee</i>	<i>-</i>	<i>To No 6 Con Depot</i>	<i>A206 BS</i>
<i>No 6 Con Depot</i>		<i>16</i>	<i>4</i>	<i>16</i>	<i>4</i>	<i>5</i>	<i>16</i>	<i>" " "</i>	<i>18.</i>	<i>To No 3 Gen Base Depot</i>	<i>A218</i>
<i>No 3 Gen Base Depot</i>		<i>4</i>	<i>5</i>	<i>16</i>	<i>6</i>	<i>5</i>	<i>16</i>	<i>" " "</i>	<i>2</i>	<i>Rejoined Unit</i>	<i>A226.</i>
<i>No 5 Can. Id. Amb.</i>		<i>21</i>	<i>6</i>	<i>16</i>	<i>21</i>	<i>6</i>	<i>16</i>	<i>g. &amp; W. 3<sup>rd</sup> Finger, 2 Hand</i>	<i>1</i>	<i>A267</i>	<i>Duplicate Medical History Sheet posted to here.</i>
<i>No 4 " " "</i>		<i>21</i>	<i>6</i>	<i>16</i>	<i>24</i>	<i>6</i>	<i>16</i>	<i>" " "</i>	<i>3</i>	<i>D to D</i>	



Rank \_\_\_\_\_ Name **COCHRANE Edward. Sam** Reg'l No. **59174.**  
 Unit **21st Bn** If in perm. Corps, }  
 What Unit? } Married or Single **Single**

Place and Date of Enlistment **Kingston. Ont. 3rd Nov. 1914.** Place of Birth **Cleveland. Ohio. USA.**

Name and Address, Next-of-Kin **Mrs. J.F. Cochrane. Grafton. Ont.**

N/E. R.B. No. \_\_\_\_\_  
 File R.L. **25-C-1829**  
 Category **KA.**

Assigned Pay Monthly \$ \_\_\_\_\_ Relationship \_\_\_\_\_

Separation Allowance \$ \_\_\_\_\_ Relationship \_\_\_\_\_

**N E R B Serial NO 2.**

Discharge, Date and Place \_\_\_\_\_ Reason \_\_\_\_\_ Relationship \_\_\_\_\_

**RCL 25-C-1829**

*M.X.  
23/11/20 M.J.*

**M**  
*Station*

Report		Record of promotions, reductions, transfers, casualties, etc., during active service. The authority to be quoted in each case.	Place	Date	REMARKS Taken from Official Documents
Date	From whom received				
19.5.15.	O.C. 21 <sup>st</sup>	Arrived per R.M.S. Inabagama	England	15.5.15.	Infus: Form.
14-7-15	O.C. 21 <sup>st</sup>	Transferred to Monks Horton	West Sandling	16-7-15	Part II Orders No 207
23.8.15	W.O.	Const. Home Pneumonia	Monks Horton H.	14.7.15	bas. list 26
5.9.15	O.C. { Monks Horton }	"	Discharged to duty. W. Sandling	5/9/15	AT. W. 3016
2.9.15	O.C. 21 <sup>st</sup>	Trans: No 2 Coy to depot Coy.	" "	2.9.15	Part II. 247
6.9.15	W.O. 21 <sup>st</sup>	Fit for duty. Discharged.	" "	5.9.15	Casualty list 30
7.9.15	O.C. 21 <sup>st</sup>	Dis: from Monks Horton Hos	" "	4.9.15	Part II. No 251
9.9.15	" "	Trans from depot to No 2 Coy	" "	9.9.15	" " 253
8.10.15	" "	Embarked for France	Folkestone	14.9.15	Inform Form

*KA.*



139-37

62

Report		Record of promotions, reductions, transfers, casualties, etc., during active service. The authority to be quoted in each case.	Place	Date	REMARKS Taken from Official Documents
Date	From whom received				
23-10-15	O.C. 21 <sup>st</sup>	Sentenced to 2 days F.P. No. 2 for absence from C.O.'s Parade.	France	2-10-15	Part II. No. 5 Field
18-4-16	21 <sup>st</sup> Bn	Adm. No. 18 Gen. Works	Camiers	8-4-16	C.L.A. 198 G.S.W. R. Knee Lt. M5342
28-4-16	"	Transf. to No. 6 Convalescent Depot	Etaples	16-4-16	" 206 " "
13-5-16	"	Proceeding to join Unit	In the Field	4-5-16	" 218 " "
24-5-16	"	Rejoined Unit	"	6-5-16	" 226 " "
30-6-16	"	App'd L. 1/1/16 on Pay.	"	26-5-16	" 2026.
13-7-16	"	No. 5 Can. Field Ambr.	"	21-6-16	C.L.A. 267. G.S.W. 3 <sup>rd</sup> finger L. Hand. M 9671.
13-7-16	"	No. 4 Can. Field Ambr.	"	21-6-16	" do "
24-7-16	"	Dis to Duty	"	24-6-16	" 275 "
14-8-16	"	Rejoined Unit	"	2-7-16	" 292
30-9-16	"	Killed in Action	"	15/17/9/16	Part II 53
5/10/16	"	ditto	"	15/17/9/16	C.L.A. 335 ON



MEDICAL CASE SHEET.\*

No. in Admission and Discharge Book.	Regimental No. <i>59174</i>	Rank. <i>Pte.</i>	Surname. <i>Cochrane</i>	Christian Name. <i>Edward J.</i>
Year <i>1915</i>	Unit. <i>21st Bn.</i>	Age. <i>19</i>	Service. <i>10/12</i>	
Station and Date.	Disease <u><i>Pneumonia</i></u>			
CANADIAN CONVALESCENT HOSPITAL MONKS HORTON, NEAR HYTHE, KENT.	<i>Admitted 14/7/15.</i>			
	<i>Discharged 4/9/15</i>			
	<i>Reported sick at Sandringham Camp 7/6/15.</i>			
	<i>Admitted to Moore B. Can. H. (1 mon)</i>			
	<i>Thence to C.C. H. Monks' Horton.</i>			
	<i>No disability; fit for duty.</i>			
	<i>J. H. Lynn M.D.</i>			

*1373*

\*The first and last entries will be signed, and transfers from one Medical Officer to another, attested by their signatures.



Station  
and Date.

MEDICAL CASE SHEET



MILITIA AND DEFENCE  
**ASSIGNED PAY**

M. F. W. 12a.  
 60m.-12-15.  
 1772-39-819.

33

Sheet No. 2.

L. L. Job 89002.-Req. 6213.

*Mrs. J. F. Cochrane*  
 OVERSEAS CONTINGENTS  
 PAYMENTS.

Name of Soldier *Cochrane, E.*  
 # *287* "*E*" 21<sup>st</sup> *Batt*"

Month.	Year.	Cheque No.	Amt.	Remarks.
				<b>\$ 20<sup>00</sup></b>
April	1916	<i>H 1879</i>	<i>20</i>	
May		<i>O 4367</i>	<i>20</i>	
June		<i>P 7784</i>	<i>20</i>	
July		<i>E 7218</i>	<i>20</i>	
Aug.		<i>H 11363</i>	<i>20</i>	
Sept.		<i>P 17568</i>	<i>20</i>	
Oct.		<i>P 22215</i>	<i>20</i>	
Nov.		<i>X 26778</i>	<i>20</i>	
Dec.				
Jan.	1917			
Feb.				
March				
April				
May				
June				
July				
Aug.				
Sept.				
Oct.				
Nov.				
Dec.				
Jan.	1918			
Feb.				
March				
April				
May				
June				
July				

*Cancelled*

*Apr Recy 24/11/16 L*  
*Killed in Action*  
*Casualty*  
*ac closed Nov. 1. 1916.*  
*\$ 20<sup>00</sup> Nov. 1916. to adj. Oct. 21/16.*  

*Casualties*

  
*360<sup>00</sup> £ 8 x 11/13/17*  
*Pension granted 18/9/16 S.A.*  
*12/2/17*



MILITIA AND DEFENCE  
**ASSIGNED PAY**  
 OVERSEAS CONTINGENTS

Sheet No. 2 (Contd.)

PAYMENTS.

Name of Soldier.....

Month.	Year.	Cheque No.	Amt.	Remarks.
Aug.	1918			
Sept.				
Oct.				
Nov.				
Dec.				
Jan.	1919			
Feb.				
March				
April				
May				
June				
July				
Aug.				
Sept.				
Oct.				
Nov.				
Dec.				
Jan.	1920			
Feb.				
March				
April				
May				
June				
July				
Aug.				
Sept.				
Oct.				
Nov.				



Rank *Lieut* Name **COCHRANE Edward. S.**

Reg'l No. **59174.**

Unit **21st Bn**

If in perm. Corps,  
What Unit?

Married or Single **Single**

Place and Date of Enlistment **Kingston. Ont. 3rd Nov. 1914.** Place of Birth **Cleveland. Ohio. USA.**

Name and Address, Next-of-Kin **Mrs. J.F. Cochrane. Grafton. Ont.**

Assigned Pay Monthly \$ **20.** Payable to *Next of Kin* Relationship

Separation Allowance \$ Payable to Relationship

Discharge, Date and Place *17-9-16. Kin A.* Reason *Field* Character

*Entered on N.E. Card Index*  
*Checked by [Signature]*

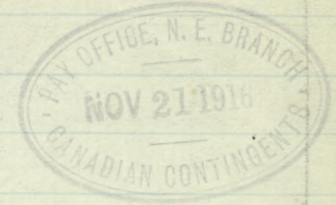

Date		PAY			Field Allowance			Other Credits	Total Credits	Voucher		Cash Payments	Assigned pay	Other Charges	Total Debits	Balance	Remarks, Casualties, etc.
From	To	No. of Days	Rate	Amount	No. of Days	Rate	Amount			No.	Date						
June 1/7	June 31/7	30	1.00	30	30	.10	3	-66	32 34			✓	20		20	12 34	Dr. Bal. May
		31	"	31	31	"	310		34 10			15	20		35	11 44	
								40	40							11 84	Exchange
1/8	3/8	31	.	31	31	.	3 10		34 10			853	20		28 53	17 41	
1/9	3/9	30	.	30	30	.	2		33			536	20		25 36	25 05	2 days 3/4 30.5
1/10	3/10	31	.	31	31	.	3 10		34 10			261	20	2	24 61	34 54	
1/11	3/11	30	.	30	30	.	3		33			268	20		22 68	44 86	
1/12	3/12	31	.	31	31	.	3 10		34 10			1152	20		31 54	47 42	
1/14	3/14	31	.	31	31	.	3 10		34 10			785	20		27 85	53 67	
1/16	2/16	29	.	29	29	.	2 90		31 90			523	20		25 23	60 34	
1/13/16	3/13/16	31	.	31	31	.	3 10		34 10			261	20	11	25 33	69 11	Q.M.S. chgo JANU
				305			30 50	40	33 54			640	20	11	26 13		
				305			30 50	40	33 54			640	200	211	26 13	69 11	

Statement of  
FEB 26 1917  
Account rendered

Cash found in effects *N. R.*

BALANCE TRANSFERRED TO NEW LEDGER.  
*Settled*

Checked *C.N. Robertson*







MILITIA AND DEFENCE  
ASSIGNED PAY  
OVERSEAS CONTINGENTS

32

To Whom *Mrs J F Cochrane*  
Address *Grafton*  
*Ont*

By Whom Assigned *Cochrane E S*  
Regtl. No. *287* *59174*  
Rank *P-1e*  
Corps *C. Coy. 21st. Battr*

Rate *\$ 20 00*

MAY 1 1915

## PAYMENTS

Month	Year	Cheque No.	Amt.	REMARKS
Aug.	1914			Issue cheque for Nov. 1916 to bal Oct. 1916. \$20 <sup>00</sup> . acc closed Nov. 1. 1916. 3 m 10 <sup>10</sup> / <sub>16</sub> 21 <sup>11</sup> / <sub>16</sub>
Sept.				
Oct.				
Nov.				
Dec.				
Jan.	1915			Casualties
Feb.				
March				
April				
May		M1239	20 -	
June		N 2544	20 -	
July		N. 3850	20 -	
Aug.		O 5170	20 -	
Sept.		P 0472	20 -	
Oct.		Q 7972	20 -	
Nov.		T 7357	20 -	
Dec.		U 8955	20 -	
Jan.	1916	W 8703	20 -	
Feb.		X 12193	20 -	
March		Z 15502	20 -	

Killed in Action between Sept 15 + 17  
62 (3) 6<sup>10</sup>/<sub>16</sub> 19<sup>10</sup>/<sub>16</sub> 96



Handwritten text, possibly a date or reference number, including "300119" and "200009".



*[Handwritten initials]*

WAR SERVICE GRATUITY

Register No. *D. 6. 405'*

TO

A.P. File No. ....

DEPENDENTS OF DECEASED SOLDIERS

Reg'tl No. *59174* Name *Edward Sam* *Cochrane*  
(Christian Name) (Surname)  
 Unit *21st Bn.* Rank *L. Opl.* Date of enlistment .....  
 Date of casualty *Between 15th + 17th Sept. 1916* B.P.C. File No. *9378*  
 Was service performed overseas? *yes*

DEPENDENT

Name *Mr. John Cochrane* Relationship *Father*  
 Address *Grafton*  
*Ont.*

Amount of Special Pension Bonus \$ *Nil* Abstracted by *A. Quinn*

Eligible for Gratuity ..... \$ .....  
 Less amount of Special Pension Bonus paid ..... \$ .....  
 Less Debit Balance of S. A. or A.P. .... \$ .....  
 Total deductions \$ .....  
 Balance due \$ .....

Cheque No. .... Date issued .....

REMARKS: *not eligible no S.A. paid*

Clerk *J. Lehaut*

Audited by *[Signature]*  
 Date *17/1/20*

M.F.W. 2652  
 25M-6-20.  
 H.Q. 1772-39-1473

*Noted D.G. 18/8/20*



# POST DISCHARGE PAY OFFICE

Three months pay and allowances after discharge.

Name

Surname

Christian Name

Regimental Number

Rank

Address (in full)

Unit

Original Unit

District where paid

Date of Discharge

P. D. P. Filing Number

Rates:—Regimental pay \$ \_\_\_\_\_ per diem; Field Allowance \$ \_\_\_\_\_ per diem. Separation Allowance \$ \_\_\_\_\_ per month.

L.L. 53961—M. & D. 9721

Total Credits 91 days	FIRST PAYMENT			SECOND PAYMENT			FINAL PAYMENT			Balance Overpayments to be Recovered	Total Amount Paid
	Cheque No. A	Date	Amount 30 days	Cheque No. B	Date	Amount 30 days	Cheque No. C	Date	Amount 31 days		

M. F. W. 127  
 300M-1-19  
 1772-39-1140

Remarks:







